

SUBDIVISION & CONSOLIDATION PLAN
FOR
PORTIONS 66 & 67 BRAKKLOOF NO. 443

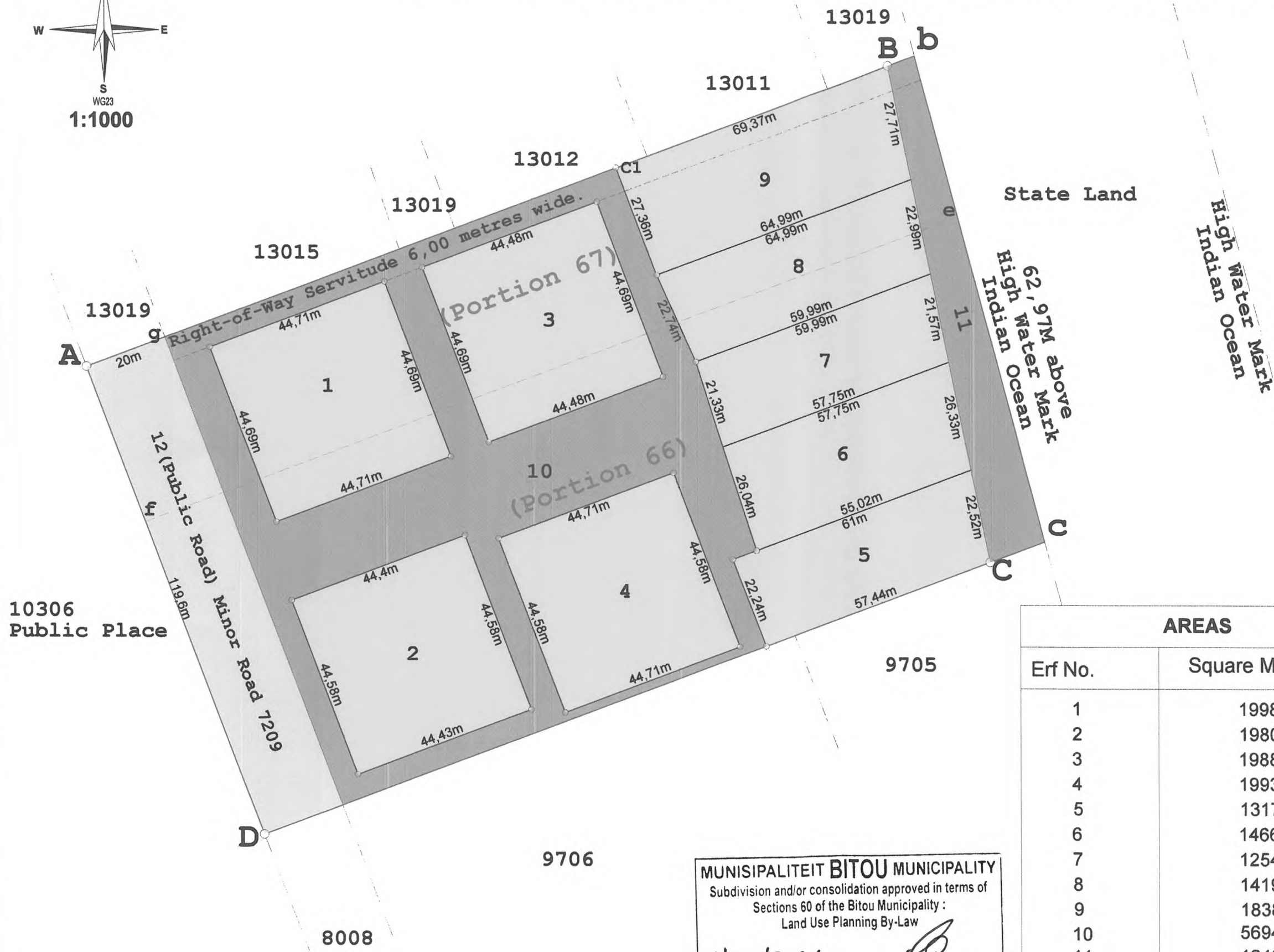

LEGEND:			
ERF NR	ZONING	LAND USE	AREA (m²)
ERF 1	Single Residential	Residential	1998 m²
ERF 2	Single Residential	Residential	1980 m²
ERF 3	Single Residential	Residential	1988 m²
ERF 4	Single Residential	Residential	1993 m²
ERF 5	Single Residential	Residential	1317 m²
ERF 6	Single Residential	Residential	1466 m²
ERF 7	Single Residential	Residential	1254 m²
ERF 8	Single Residential	Residential	1419 m²
ERF 9	Single Residential	Residential	1838 m²
ERF 10	Private Open Space	Communal Area	5694 m²
ERF 11	Private Open Space	Communal Area	1248 m²
ERF 12	Transport Zone 2	Public Road	2392 m²

- NOTES:**
- Sizes and dimensions are approximate and subject final survey.
 - Figures Abef represents Portion 66 and figures fecd represents Portion 67.
 - Portion 66 to be consolidated with Portion 67.
 - The figures Abcd represents consolidated Portion 66 & 67 of Farm Brakkloof No. 443 being 2.4587 ha in extent.
- Servitude Notes:**
- The line gC1 represents the northern boundary of a Right-of-Way Servitude 6,00m wide, in favour of Portion 60 of the farm Brakkloof 433, as shown over Erf 10.
 - The line C1B represents the northern boundary of a Right-of-Way Servitude 6,00m wide in favour of Portion 60 of the farm Brakkloof 433 as shown over Portion 9.
 - The line Bb represents the northern boundary of Right-of-Way Servitude 6,00m wide in favour of Portion 60 of the farm Brakkloof 433 as shown over Erf 11

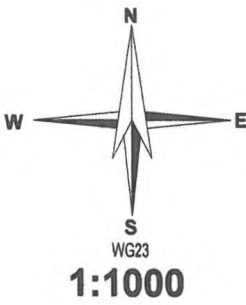
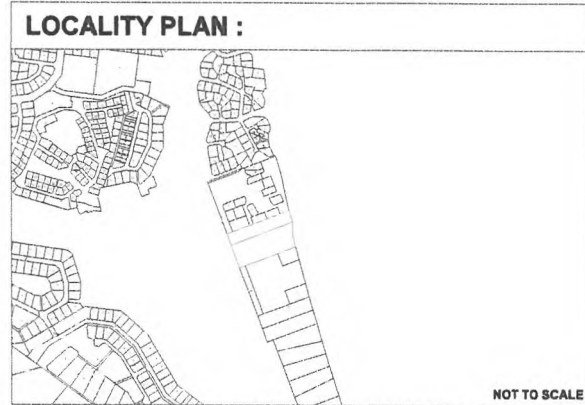

AREAS	
Erf No.	Square Meters
1	1998
2	1980
3	1988
4	1993
5	1317
6	1466
7	1254
8	1419
9	1838
10	5694
11	1248
12	2392

MUNISIPALITEIT BITOU MUNICIPALITY
Subdivision and/or consolidation approved in terms of
Sections 60 of the Bitou Municipality :
Land Use Planning By-Law
01/02/2024
DATE MUNICIPAL MANAGER
DATUM MUNISIPALE BESTUURDER

PTN 66 & 67 BRAKKLOOF NO. 443

DRW NR.: 66/67-SUB2

BITOU MUNICIPAL AREA

DATE : 29 NOVEMBER 2023

Planning Space
Town and Regional Planners
Quayside Office Park, Corner of Hedges & Gordon Street, Unit 6 Ground Floor
Hedgeburg 6010
Cell: (081) 222 0016
E-mail: admin@planningspace.co.za Website: www.planningspace.co.za

COPY RIGHT:
This Plan may not be copied or amended without the written consent of Planning Space